



KONICA MINOLTA

bizhub 654e

Black & white A3 multifunctional

Up to 65 pages per minute

Functionality



Copying

- Black & white



Printing

- Black & white
- PCL/PS
- Local/Network
- USB



Scanning

- Colour
- Black & white
- Scan-to-eMail
- Scan-to-Me
- Scan-to-SMB
- Scan-to-Home
- Scan-to-FTP
- Scan-to-Box
- Scan-to-USB
- Scan-to-WebDAV
- Scan-to-DPWS
- TWAIN Network



Faxing

- Super G3 Fax
- PC-Fax
- i-Fax
- IP-Fax



Box

- Reprint
- Distribution
- Sharing
- Box-to-Box
- Box-to-USB



Giving Shape to Ideas

Technology

Emperon™ – print controller	Easily compatible with different users and IT environments through Konica Minolta's unified print technology	✓
Simitri® HD – polymerised toner	Delivers high print quality and yet ensures reduced print spending as well as lower environmental impact	✓
OpenAPI – solution platform	Server-based applications provide efficient workflows for the entire MFP fleet	✓
i-Option – special feature	Offers extended scope and advanced MFP functionality in line with individual requirements	✓
CSRC – remote service	Keeps productivity up with online monitoring of devices and consumables through the Konica Minolta service	✓
IWS – panel customisation	Improved user-device interaction and enhanced productivity through full MFP panel customisation	✓

Option diagram

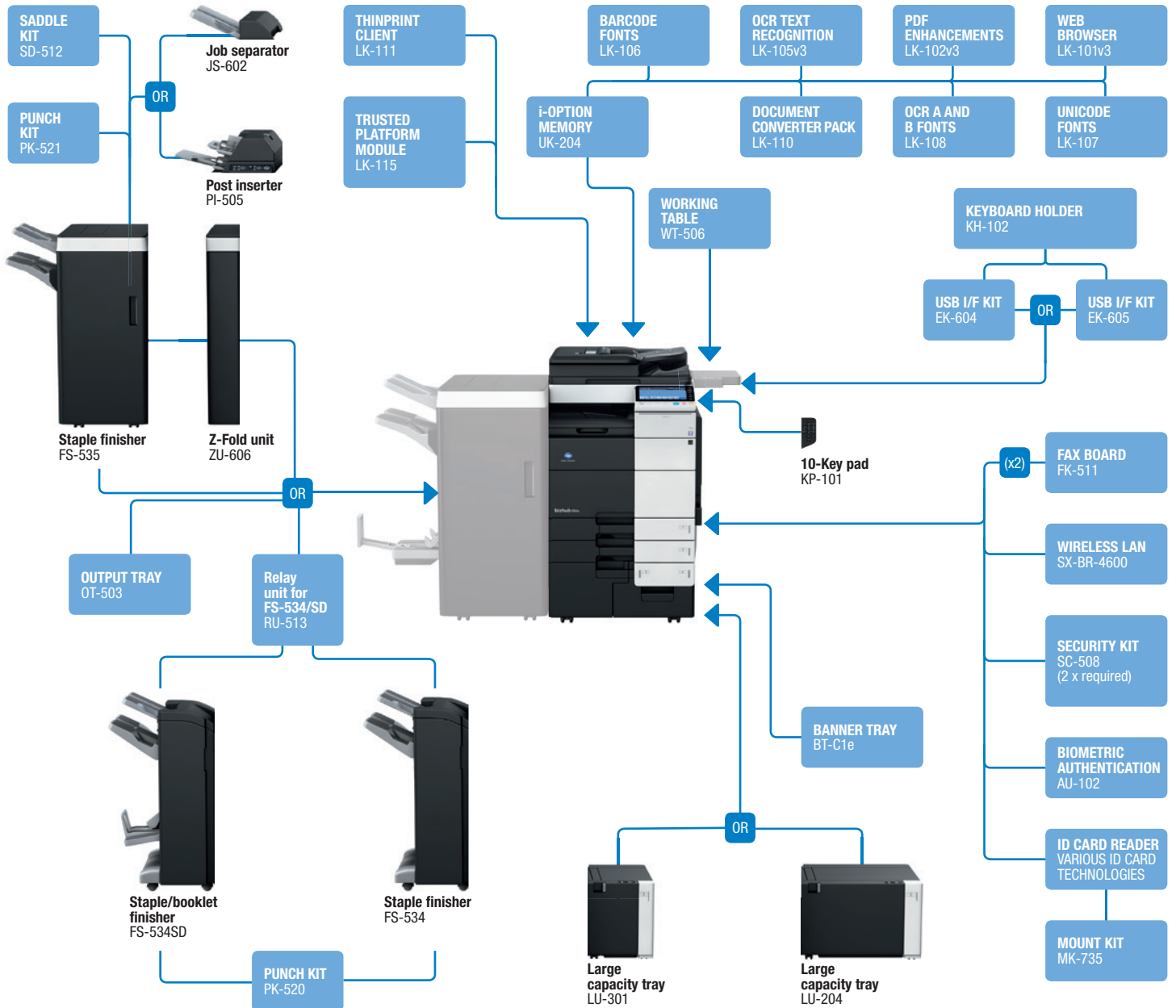

Finishing functionalities

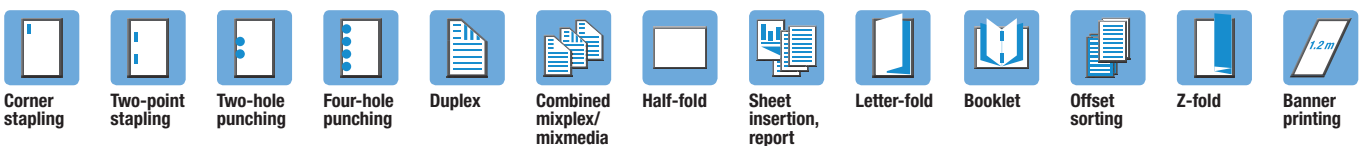

Descriptions

bizhub 654e	Communication centre with 65 ppm b/w. Standard Emperon™ print controller with PCL 6, PCL 5, PostScript 3, PDF 1.7, XPS and OOXML support. Paper capacity of 500 + 500 + 1000 + 1500 sheets and 150-sheet manual bypass. Media from A6 to SRA3, 1.2 m banner and 52–300 gsm. 2 GB memory, 250 GB hard disk and Gigabit Ethernet standard.
LU-204 Large capacity tray	A4–SRA3, 2,500 sheets, 52–256 gsm
LU-301 Large capacity tray	A4, 3,000 sheets, 52–256 gsm
FS-534 Staple finisher	50-sheet stapling, 3,200 sheets max. output
FS-534SD Booklet finisher	50-sheets staple finisher, 20-sheets booklet finisher, 2,200 sheets max. output
RU-513 Relay unit for FS-534/SD	For FS-534/SD installation
PK-520 Punch kit for FS-534/SD	2/4 hole punching, autoswitching
FS-535 Staple finisher	100 sheets stapling, 3,200 sheets max. output
PK-521 Punch kit for FS-535	2/4 hole punching, autoswitching
SD-512 Saddle kit for FS-535	Booklet finishing, half-fold, letter-fold
PI-505 Post inserter for FS-535	Cover insertion, post finishing
JS-602 Job separator for FS-535	Separation of fax output, etc.
ZU-606 Z-fold unit for FS-535	Z-fold for A3 prints, 2/4 hole punching
OT-503 Output tray	Output tray used instead of finisher
KP-101 10-Key pad	For use instead of touchscreen

WT-506 Working table	Authentication device placement
FK-511 Fax board	Super G3 fax, digital fax functionality
KH-102 Keyboard holder	To place USB keyboard
EK-604 USB I/F kit	USB keyboard connection
EK-605 USB I/F kit	USB keyboard connection, Bluetooth
ID card reader	Various ID card technologies
MK-735 Mount kit	Installation kit for ID card reader
AU-102 Biometric authentication	Finger vein scanner
SC-508 Security kit	Copy guard function
BT-C1e Banner tray	Multi-page banner feeding
LK-101v3 Web browser	Web browser and IWS
LK-102v3 PDF enhancements	PDF/A, PDF encryption, digital signature
LK-105v3 OCR text recognition	Searchable PDF and PPTX
LK-106 Barcode fonts	Supports native barcode printing
LK-107 Unicode fonts	Supports native Unicode printing
LK-108 OCR A and B fonts	Supports native OCR A and B font printing
LK-110 Document converter pack	Generates various file formats incl. DOCX, XLSX and PDF/A
LK-111 ThinPrint® Client	Print data compression for reduced network impact
LK-115 TPM activation	Trusted Platform Module for protection of data encryption and decryption
UK-204 i-Option memory	Memory extension for i-Options
SX-BR-4600 Wireless LAN	Wireless LAN to network connector

Technical specifications

SYSTEM SPECIFICATIONS

System memory	2,048 MB
System hard disk	250 GB
Interface	10-Base-T/100-Base-T/1,000-Base-T Ethernet; USB 2.0 Wi-Fi 802.11b/g (optional)
Network protocols	TCP/IP (IPv4 / IPv6); IPX/SPX; NetBEUI; AppleTalk (EtherTalk); SMB; LPD; IPP; SNMP; HTTP
Frame types	Ethernet 802.2; Ethernet 802.3; Ethernet II; Ethernet SNAP
Automatic document feeder	Up to 150 originals; A6–A3; 35–210 gsm Dualscan ADF
Printable paper size	A6–SRA3, customised paper sizes; banner paper max. 1,200 x 297 mm
Printable paper weight	52–300 gsm
Paper input capacity	Standard: 3,650 sheets Max.: 6,650 sheets
Tray 1	500 sheets, A5–SRA3, 52–256 gsm
Tray 2	500 sheets, A5–SRA3, 52–256 gsm
Tray 3	1,500 sheets, A4, 52–256 gsm
Tray 4	1,000 sheets, A4, 52–256 gsm
Large capacity tray LU-301 (optional)	3,000 sheets, A4, 52–256 gsm
Large capacity tray LU-204 (optional)	2,500 sheets, A4–SRA3, 52–256 gsm
Manual bypass	150 sheets, A6–SRA3, custom sizes, banner, 52–300 gsm
Automatic duplexing	A5–SRA3; 52–256 gsm
Finishing modes (optional)	Offset; group; sort; staple; punch; post insertion; z-fold; centre-fold; letter fold; booklet
Output capacity (with finisher)	Max.: 3,300 sheets
Output capacity (without finisher)	Max.: 250 sheets
Stapling	Max.: 100 sheets or 94 sheets + 2 cover sheets (up to 209 gsm)
Stapling output capacity	Max.: 1,000 sheets
Letter fold	Up to 3 sheets
Letter fold capacity	Max.: 30 sheets (tray); unlimited
Booklet	Max.: 20 sheets or 19 sheets + 1 cover sheet (up to 209 gsm)
Booklet output capacity	Max.: 100 sheets (tray); unlimited
Copy/print volume (monthly)	Rec.: 80,000 pages; Max.: 187,000 pages
Toner lifetime	48,960 pages

Imaging unit lifetime	300,000 pages/1,200,000 pages (Drum/Developer)
Power consumption	220–240 V / 50/60 Hz Less than 2.1 kW (system)
System dimensions (W x D x H)	650 x 799 x 1,155 mm
System weight	Approx. 201 kg

COPIER SPECIFICATIONS

Copying process	Electrostatic laser copy, tandem, indirect
Toner system	Simitri® HD polymerised toner
Copy/print speed A4	Up to 65 ppm
Copy/print speed A3	Up to 33 ppm
Autoduplex speed A4	Up to 65 ppm
1st copy out time	3.7 sec.
Warm-up time	Approx. 22 sec. ²
Copy resolution	600 x 600 dpi
Gradation	256 gradations
Multicopy	1–9,999
Original format	A5–A3
Magnification	25–400% in 0.1% steps; auto-zooming
Copy functions	Chapter; cover and page insertion; proof copy (print and screen); adjustment test print; digital art functions; job setting memory; poster mode; image repeat; overlay (optional); stamping; copy protection

¹ If the maximum volume is reached within a period of one year, then a maintenance cycle must be performed

² Warm-up time may vary depending on the operating environment and usage

PRINTER SPECIFICATIONS

Print resolution	1,800 x 600 dpi; 1,200 x 1,200 dpi
Page description language	PCL6 (XL 3.0); PCL 5; PostScript 3 (CPSI 3016); XPS
Operating systems	Windows VISTA (32/64) Windows 7 (32/64) Windows 8 (32/64) Windows 10 (32/64) Windows Server 2008 (32/64) Windows Server 2008 R2 Windows Server 2012 Windows Server 2012 R2 Macintosh OS X 10.x Unix, Linux, Citrix
Printer fonts	80 PCL Latin; 137 PostScript 3 Emulation Latin
Print functions	Direct print of PCL, PS, TIFF, XPS, PDF (v1.7), encrypted PDF files and OOXML (DOCX, XLSX, PPTX); mixmedia and mixplex; "Easy Set" job programming; overlay; watermark; copy protection; carbon copy print
Mobile Printing	AirPrint (iOS), Mopria (Android), Google Cloud Print (optional), Konica Minolta Print Service (Android), PageScope Mobile (iOS & Android)

SCANNER SPECIFICATIONS

Scan speed (mono/colour)	Up to 180 ipm
Scan resolution	Max.: 600 x 600 dpi
Scan modes	Scan-to-eMail (Scan-to-Me) Scan-to-SMB (Scan-to-Home) Scan-to-FTP Scan-to-Box Scan-to-USB Scan-to-WebDAV Scan-to-DPWS Network TWAIN scan
File formats	JPEG; TIFF; PDF; PDF/A 1a and 1b (optional); Compact PDF; encrypted PDF; searchable PDF (optional); XPS; compact XPS; PPTX and searchable PPTX (optional); searchable DOCX/ XLSX (optional)
Scan destinations	2,100 (single + group); LDAP support
Scan functions	Annotation (text/time/date) for PDF; up to 400 job programs; realtime scan preview

FAX SPECIFICATIONS

Fax standard	Super G3 (optional)
Fax transmission	Analogue i-Fax Colour i-Fax (RFC3949-C) IP-Fax
Fax resolution	Max.: 600 x 600 dpi (ultra-fine)
Fax compression	MH; MR; MMR; JBIG
Fax modem	Up to 33.6 Kbps
Fax destinations	2,100 (single + group)
Fax functions	Polling; time shift; PC-Fax; receipt to confidential box; Receipt to e-mail/FTP/SMB; up to 400 job programs

USER BOX SPECIFICATIONS

Max. storable documents	Up to 3,000 documents or 10,000 pages
Type of user boxes	Public Personal (with password or authentication) Group (with authentication)
Type of system boxes	Secure print Encrypted PDF print Fax receipt Fax polling
User box functionality	Reprint; combination Download Sending (e-mail/FTP/SMB and fax) Copy box to box

SYSTEM FEATURES

Security	ISO15408/IEEE 2600.1 (in evaluation); IP filtering and port blocking; SSL2; SSL3 and TLS1.0 network communication; IPsec support; IEEE 802.1x support; user authentication; Authentication log; secure print; Hard disk overwrite (8 standard types); Hard disk data encryption (AES 256); Memory data auto deletion; Confidential fax receipt; Print user data encryption; copy protection (Copy Guard, Password Copy) optional
Accounting	Up to 1,000 user accounts; Active Directory support (user name + password + e-mail + smb folder) User function access definition Biometric authentication (finger vein scanner) optional ID card authentication (ID card reader) optional"
Software	PageScope Net Care Device Manager PageScope Data Administrator PageScope Box Operator PageScope Direct Print Print Status Notifier Driver Packaging Utility Log Management Utility

- All specifications refer to A4-size paper of 80 gsm quality.
- The support and availability of the listed specifications and functionalities varies depending on operating systems, applications and network protocols as well as network and system configurations.
- The stated life expectancy of each consumable is based on specific operating conditions such as page coverage for a particular page size (5% coverage of A4). The actual life of each consumable will vary depending on use and other printing variables including page coverage, page size, media type, continuous or intermittent printing, ambient temperature and humidity.
- Some of the product illustrations contain optional accessories.
- Specifications and accessories are based on the information available at the time of printing and are subject to change without notice.
- Konica Minolta does not warrant that any specifications mentioned will be error-free.
- All brand and product names may be registered trademarks or trademarks of their respective holders and are hereby acknowledged.

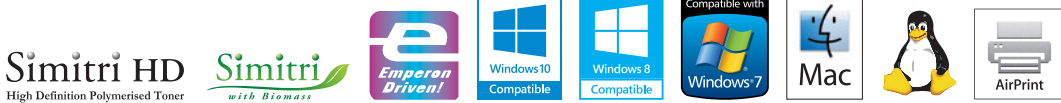

Visit our product page